

Assembly instructions for Radio Junction Box to the Intercom GL1800 GL1500

Installation of Junction Box

The Junction Box will be installed under the left front storage compartment. Remove the compartment. Disconnect the 6-pole plug from the Intercom cable from the cable harness. Connect the open sockets with the cable harness from the Junction Box. Connect the 3 pin Plug from the Junction Box with red 3 pin ACC connector under the compartment.

Installation in GL1500

The separate power cable lead to fuse box. Connect to the ACC terminals. Red = + (plus), green (black) = - (minus)

The **PTT button** mounted on the left handlebar. They are fastened by the screw for the clutch lever. Just loosen the screws on the cable channel. Press the cable into it. Then, tighten the screws. The cable lead around at the steering head and connecting with the 2 pin plug of the junction box.

Connecting the Radio

Install the Radio in a suitable place. Forward the cable from the jack plug (2,5 mm and 3,5 mm) and insert them into the corresponding sockets of the Radio.

Operation of the Radio

Switch ON the ignition (ACC). Start the Radio and choose a medium volume. Connect the helmet. Check if the Intercom and the radio both still work via the helmet. Turn down the squelch (or check by transmitting with a second (CB) Radio on the same channel). If all connections are made correctly, you should hear the rustle or the noises of the other Radio in your helmet with an acceptable volume. Using the volume control of the (CB) Radio the volume may be adjusted. As soon as the Receiver is no longer active, you should be able to listen to the normal Radio/ Intercom function. Press the PTT switch (at the handle bars) and check the communication from the motorbike to the other CB-Radio. The Junction Box is pre-installed and should work with standard adjustment.

Driver and passenger can listen to the radio interview. Only the driver can talk. The driver headset also works when turned off Intercom.

If everything works, place and secure the cables. Secure the Junction Box against humidity and splashing. Install junction box so that the cables from coming down (water drop travels along the cable).

Re-install all previously dismantled parts and double check everything.

In case of occurring problems, please do not hesitate to contact us at +49(0)4122 967690. We help you.



Klinkerstrasse 7, 25436 Moorrege, Germany
Phone 0049 4122 967690, Fax 0049 4122 967689
Mail irlbacher@w-irlbacher.de, www.w-irlbacher.de

Wiring diagram Junction box NT to Alan 42

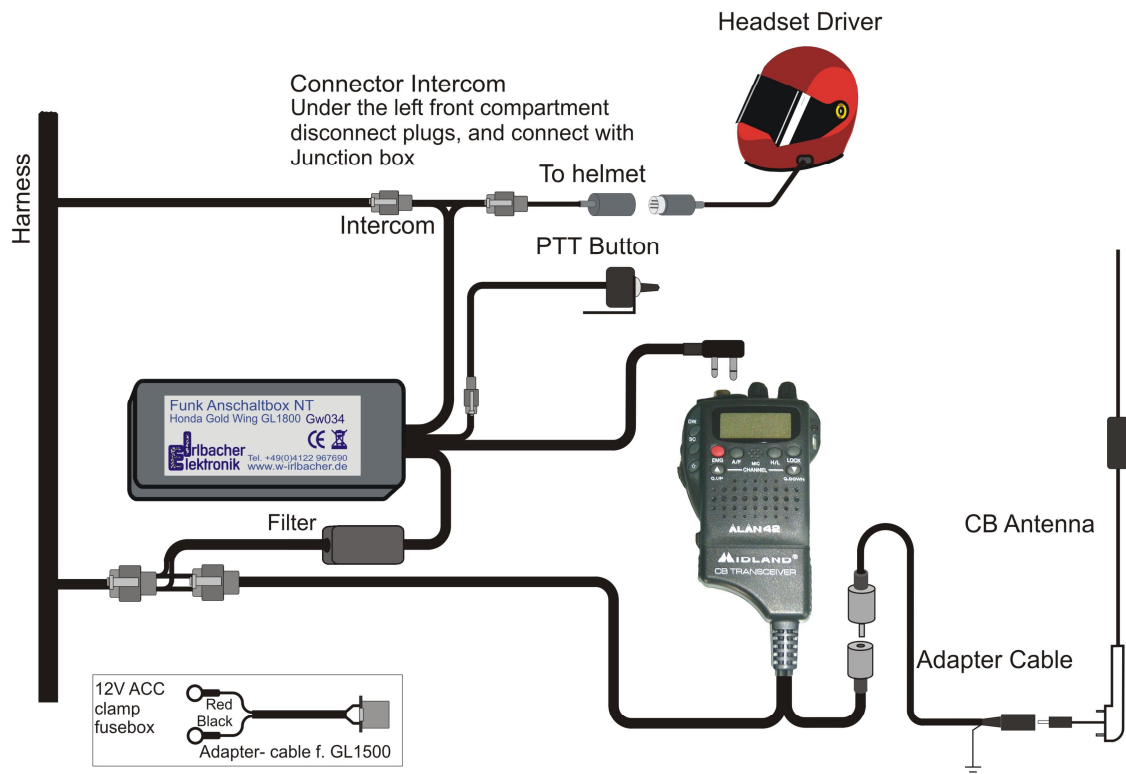

Wiring diagram Junction box NT to PMR Radio

